

Fence & Boundary Treatment



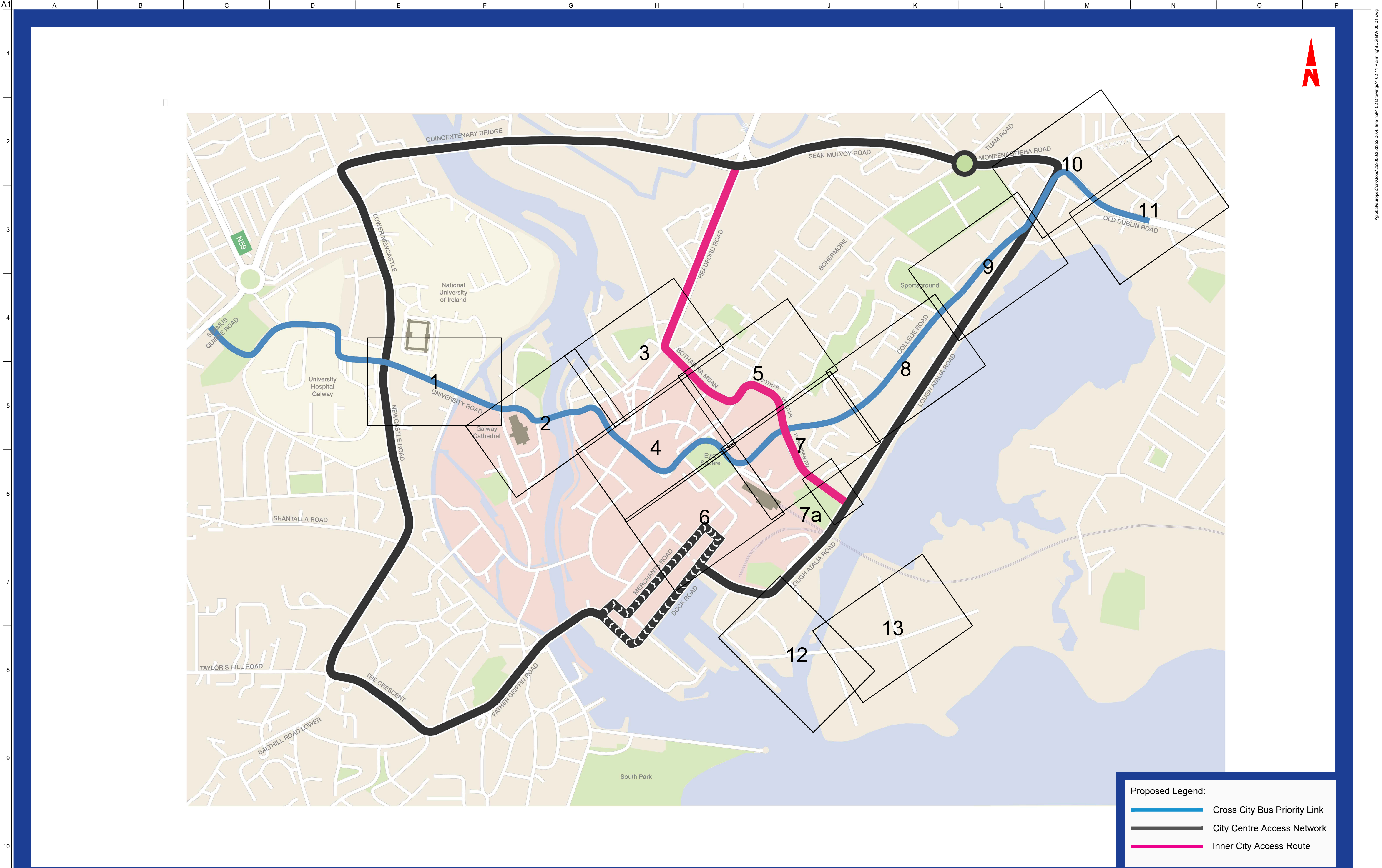
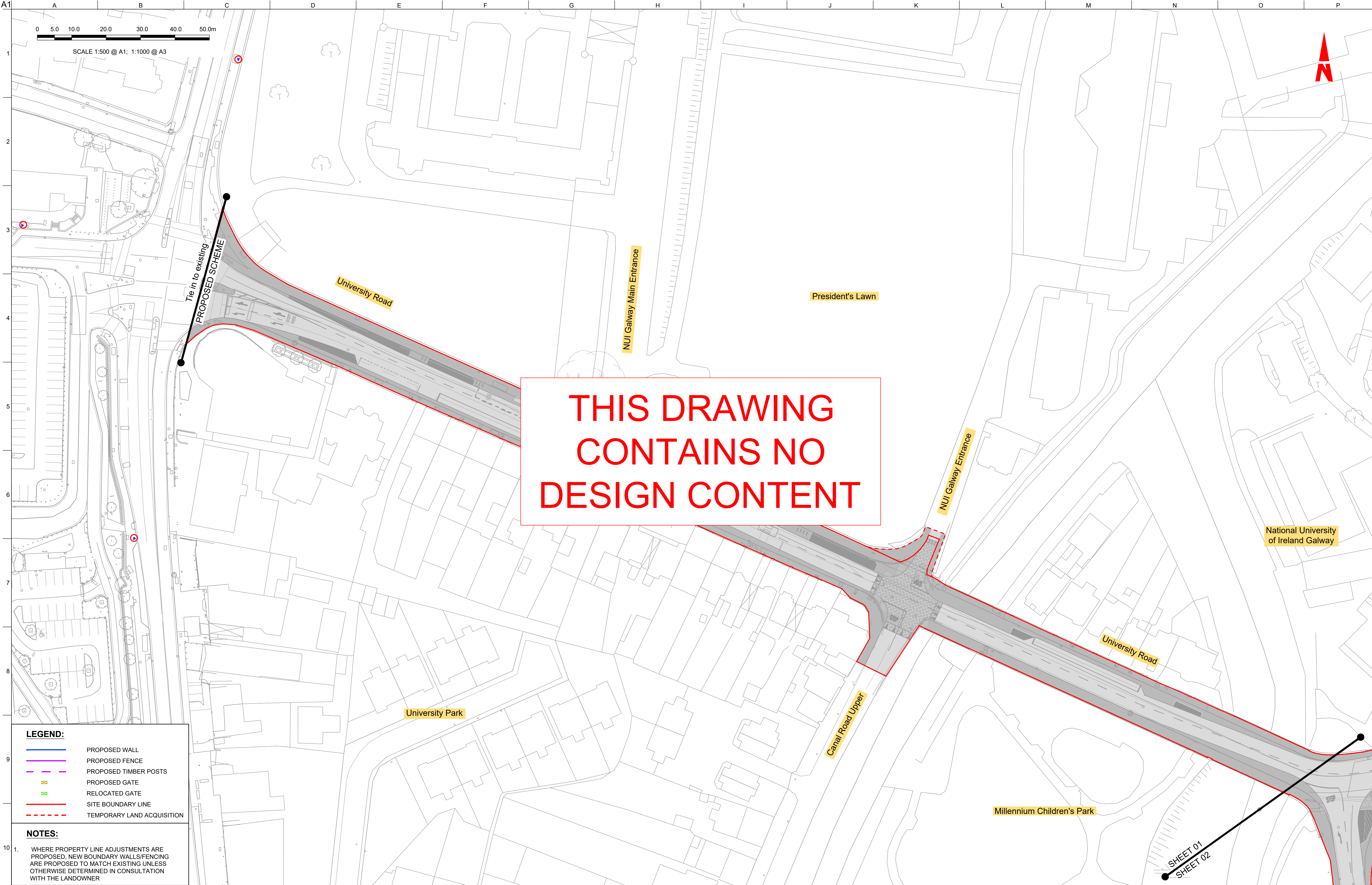

Figure 4.2 - Refer to Galway Transport Strategy Report



LEGEND:

- PROPOSED WALL
- PROPOSED FENCE
- PROPOSED TIMBER POSTS
- PROPOSED GATE
- RELOCATED GATE
- SITE BOUNDARY LINE
- TEMPORARY LAND ACQUISITION

NOTES:

1. WHERE PROPERTY LINE ADJUSTMENTS ARE PROPOSED, NEW BOUNDARY WALLS/FENCING ARE PROPOSED TO MATCH EXISTING UNLESS OTHERWISE DETERMINED IN CONSULTATION WITH THE LANDOWNER

Disclaimer

a. © Galway City Council (GCC) 2022. This drawing is confidential and the copyright in it is owned by GCC. This drawing must not be either loaned, copied or otherwise reproduced in whole or in part or used for any purpose without the prior permission of GCC.

b. This drawing is to be used for the design element identified in the titlebox. Other information shown is to be considered indicative only. The drawing is to be read in conjunction with all other relevant design drawings.

c. O.S. data used for plans are printed under © Ordnance Survey Ireland Government of Ireland. All rights reserved. Licence Number EN 0002822 (Arup). All elevations are in metres and relate to OSI Geoid Model (OSGM15) Mean Head. All Co-ordinates are in Irish Transverse Mercator Grid (ITM) as defined by OSI active local GPS station.

d. Information concerning the position of apparatus shown on this drawing is based on drawings supplied by the utility owners and/or the utility works contractor, whilst every care has been taken in the preparation of this drawing, positions should be taken as approximate and are intended for general guidance only and no representation is made by the GCC as to the accuracy, completeness, sufficiency or otherwise of this drawing and the position of the apparatus. The information contained herein does not purport to be comprehensive or final as the apparatus is subject to being altered and/or suspended. Recipients should not rely on this information. Any liabilities are hereby expressly disclaimed.

e. The information contained herein has been provided by the GCC but does not purport to be comprehensive or final. Recipients should not rely on the information. Neither the GCC nor any of its directors, officers, employees, agents, stakeholders or advisers make any representation or warranty as to, or accept any liability or responsibility in relation to, the adequacy, accuracy, reasonableness or completeness of the information provided as part of this document or any matter on which the information is based (including but not limited to loss or damage arising as a result of reliance by recipients on the information or any part of it). Any liabilities are hereby expressly disclaimed.

ARUP

Arup, One Albert Quay,
Cork, T12 X8N6, Ireland
Tel +353 (0)21 422 3200 Fax +353 (0)1 668 3169
www.arup.ie

Client
Galway City Council

Project Title
**BusConnects Galway:
Cross-City Link
(University Road to Dublin Road)**

Drawing Title
**Fence and Boundary Treatment
Sheet 01 of 13**

Scale at A1
1:500 @ A1 (1:1000 @ A3)

Role	Transport Infrastructure
Suitability	Planning
Arup Job No	253352-00
Name	BCG-BW-00-01
Rev	PL01

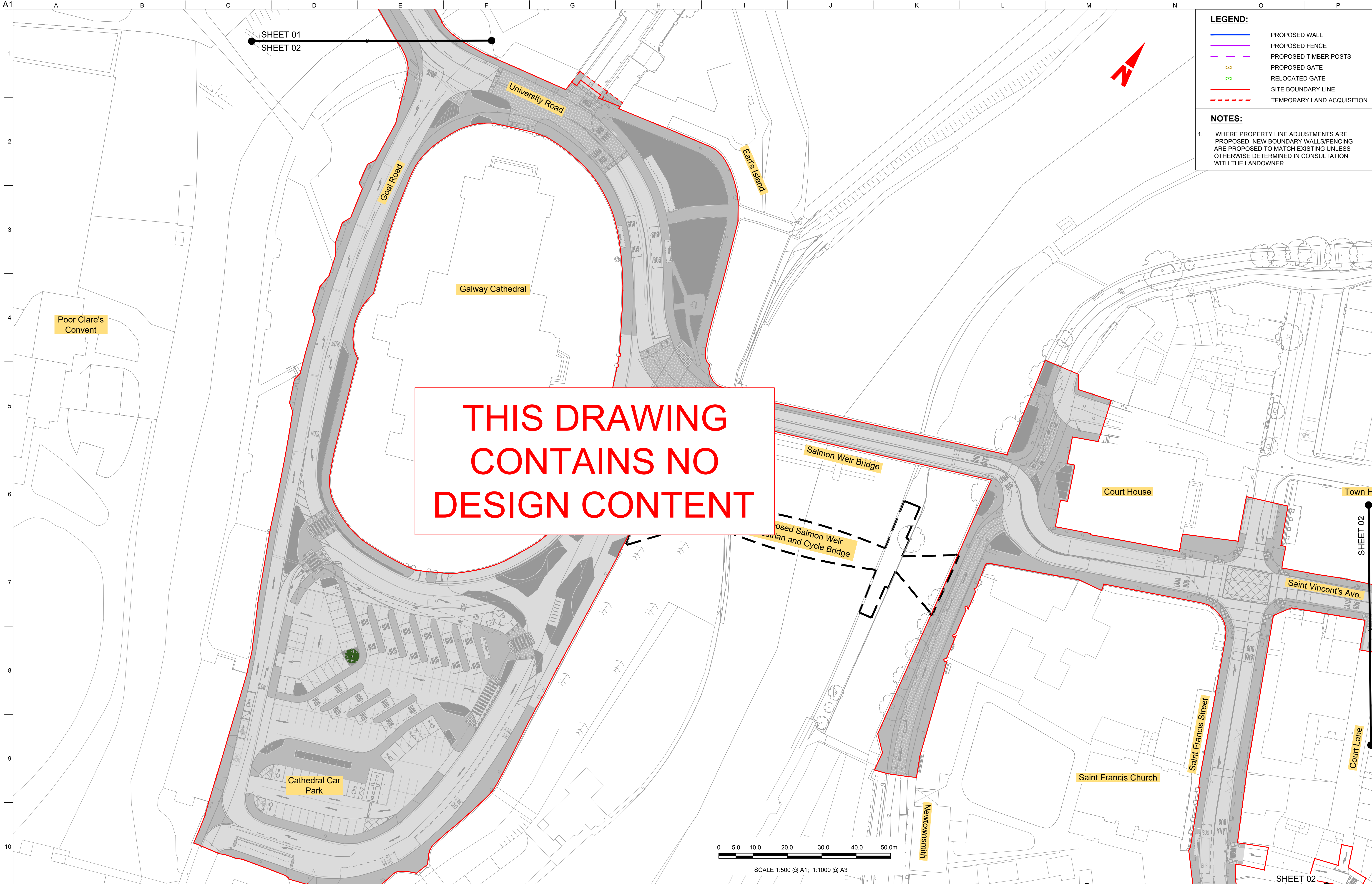

LEGEND:

PROPOSED WALL

PROPOSED FENCE

NOTES:

1. WHERE PROPERTY LINE ADJUSTMENTS ARE PROPOSED, NEW BOUNDARY WALLS/FENCING ARE PROPOSED TO MATCH EXISTING UNLESS OTHERWISE DETERMINED IN CONSULTATION WITH THE LANDOWNER

Disclaimer

a. © Galway City Council (GCC) 2022. This drawing is confidential and the copyright in it is owned by GCC. This drawing must not be either loaned, copied or otherwise reproduced in whole or in part or used for any purpose without the prior permission of GCC.

b. This drawing is to be used for the design element identified in the titlebox. Other information shown is to be considered indicative only. The drawing is to be read in conjunction with all other relevant design drawings.

c. O.S. data used for plans are printed under © Ordnance Survey Ireland Government of Ireland. All rights reserved. Licence Number EN 0002822 (Aug). All elevations are in metres and relate to OSI Geoid Model (OSGM15) Mean Sea Level. All Co-ordinates are in Irish Transverse Mercator Grid (ITM) as defined by OSI active local GPS station.

d. Information concerning the position of apparatus shown on this drawing is based on drawings supplied by the utility owners and/or the utility works contractor, whilst every care has been taken in the preparation of this drawing, positions should be taken as approximate and are intended for general guidance only and no representation is made by the GCC as to the accuracy, completeness, sufficiency or otherwise of this drawing and the position of the apparatus. The information contained herein does not purport to be comprehensive or final as the apparatus is subject to being altered and/or suspended. Recipients should not rely on this information. Any liabilities are hereby expressly disclaimed.

e. The information contained herein has been provided by the GCC but does not purport to be comprehensive or final. Recipients should not rely on the information. Neither the GCC nor any of its directors, officers, employees, agents, stakeholders or advisers make any representation or warranty as to, or accept any liability or responsibility in relation to, the adequacy, accuracy, reasonableness or completeness of the information provided as part of this document or any matter on which the information is based (including but not limited to loss or damage arising as a result of reliance by recipients on the information or any part of it). Any liabilities are hereby expressly disclaimed.

NTA

Údarás Náisiúnta Iompair

National Transport Authority

PL01

31/08/22

BM

BB

DMcD

Issue for Planning

Rev	Date	By	Chkd	Appd

ARUP

Arup, One Albert Quay,
Cork, T12 X8N6, Ireland
Tel +353 (0)21 422 3200 Fax +353 (0)1 668 3169
www.arup.ie

Client

Galway City Council

Project Title

BusConnects Galway:
Cross-City Link
(University Road to Dublin Road)

Drawing Title

Fence and Boundary Treatment
Sheet 02 of 13

Scale at A1

1:500 @ A1 (1:1000 @ A3)

Role	Transport Infrastructure	Rev
Suitability	Planning	
Arup Job No	253352-00	PL01
Name	BCG-BW-00-02	

Do not scale

Map reproduced from Ordnance Survey Ireland Licence No. EN 0002822
© Ordnance Survey Ireland/ Government of Ireland.

© Arup

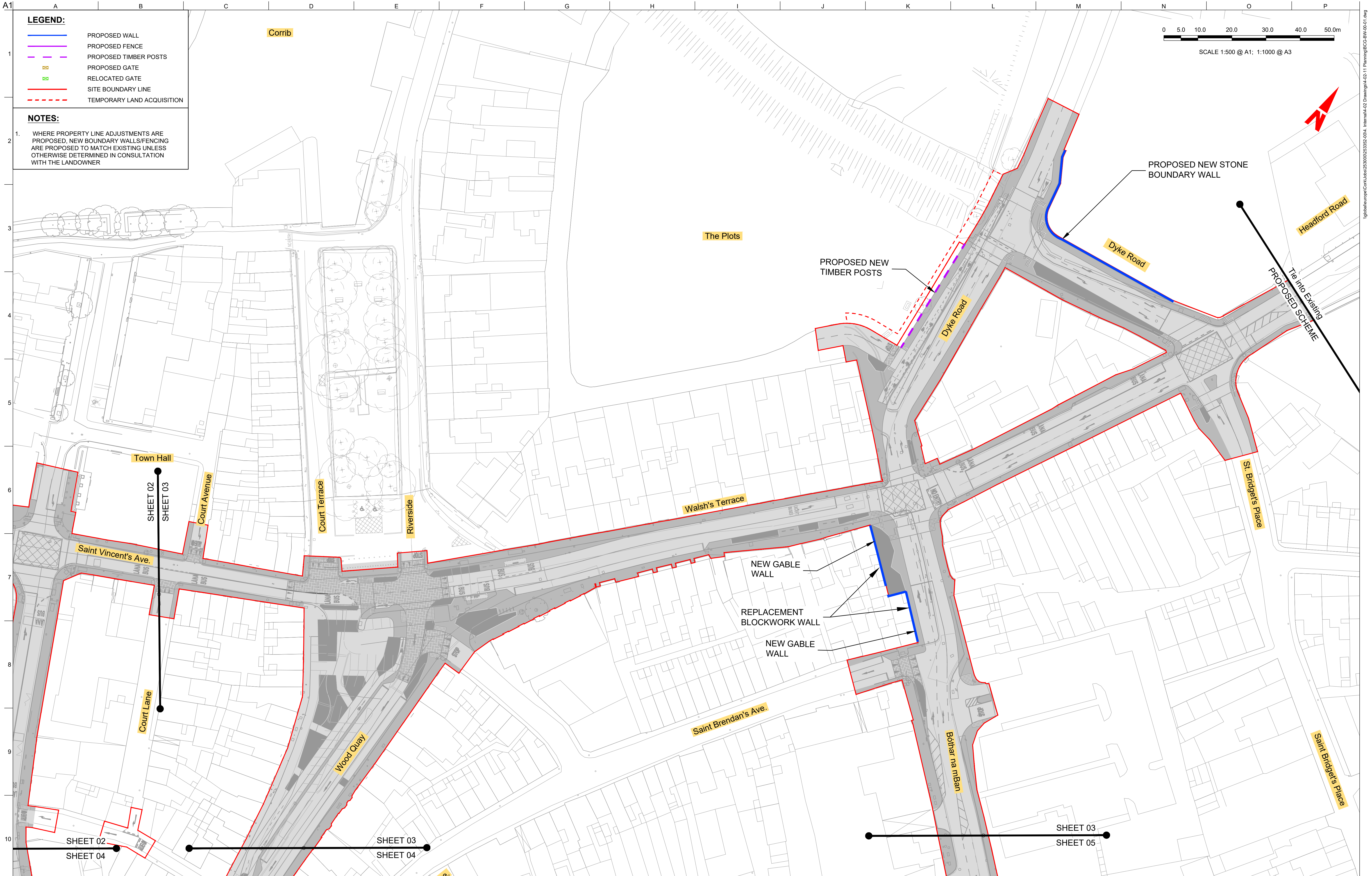

LEGEND:

- PROPOSED WALL
- PROPOSED FENCE
- PROPOSED TIMBER POSTS
- PROPOSED GATE
- RELOCATED GATE
- SITE BOUNDARY LINE
- TEMPORARY LAND ACQUISITION

NOTES:

1. WHERE PROPERTY LINE ADJUSTMENTS ARE PROPOSED, NEW BOUNDARY WALLS/FENCING ARE PROPOSED TO MATCH EXISTING UNLESS OTHERWISE DETERMINED IN CONSULTATION WITH THE LANDOWNER

Disclaimers

a. © Galway City Council (GCC) 2022. This drawing is confidential and the copyright in it is owned by GCC. This drawing must not be either loaned, copied or otherwise reproduced in whole or in part or used for any purpose without the prior permission of GCC.

b. This drawing is to be used for the design element identified in the titlebox. Other information shown is to be considered indicative only. The drawing is to be read in conjunction with all other relevant design drawings.

c. O.S. data used for plans are printed under © Ordnance Survey Ireland Government of Ireland. All rights reserved. Licence Number EN 0002822 (Anup). All elevations are in metres and relate to OSI Geoid Model (OSGM15) Mean Head. All Co-ordinates are in Irish Transverse Mercator Grid (ITM) as defined by OSI active local GPS station.

d. Information concerning the position of apparatus shown on this drawing is based on drawings supplied by the utility owners and/or the utility works contractor, whilst every care has been taken in the preparation of this drawing, positions should be taken as approximate and are intended for general guidance only and no representation is made by the GCC as to the accuracy, completeness, sufficiency or otherwise of this drawing and the position of the apparatus. The information contained herein does not purport to be comprehensive or final as the apparatus is subject to being altered and/or superseded. Recipients should not rely on this information. Any liabilities are hereby expressly disclaimed.

e. The information contained herein has been provided by the GCC but does not purport to be comprehensive or final. Recipients should not rely on the information. Neither the GCC nor any of its directors, officers, employees, agents, stakeholders or advisers make any representation or warranty as to, or accept any liability or responsibility in relation to, the adequacy, accuracy, reasonableness or completeness of the information provided as part of this document or any matter on which the information is based (including but not limited to loss or damage arising as a result of reliance by recipients on the information or any part of it). Any liabilities are hereby expressly disclaimed.

ARUP

Anup, One Albert Quay,
Cork, T12 X8N6, Ireland
Tel +353 (0)21 422 3200 Fax +353 (0)1 668 3169
www.arup.ie

Client
Galway City Council

Project Title
**BusConnects Galway:
Cross-City Link
(University Road to Dublin Road)**

Drawing Title
**Fence and Boundary Treatment
Sheet 03 of 13**

Scale at A1
1:500 @ A1 (1:1000 @ A3)

Role	Transport Infrastructure
Suitability	Planning
Arup Job No	253352-00
Name	BCG-BW-00-03
Rev	PL01

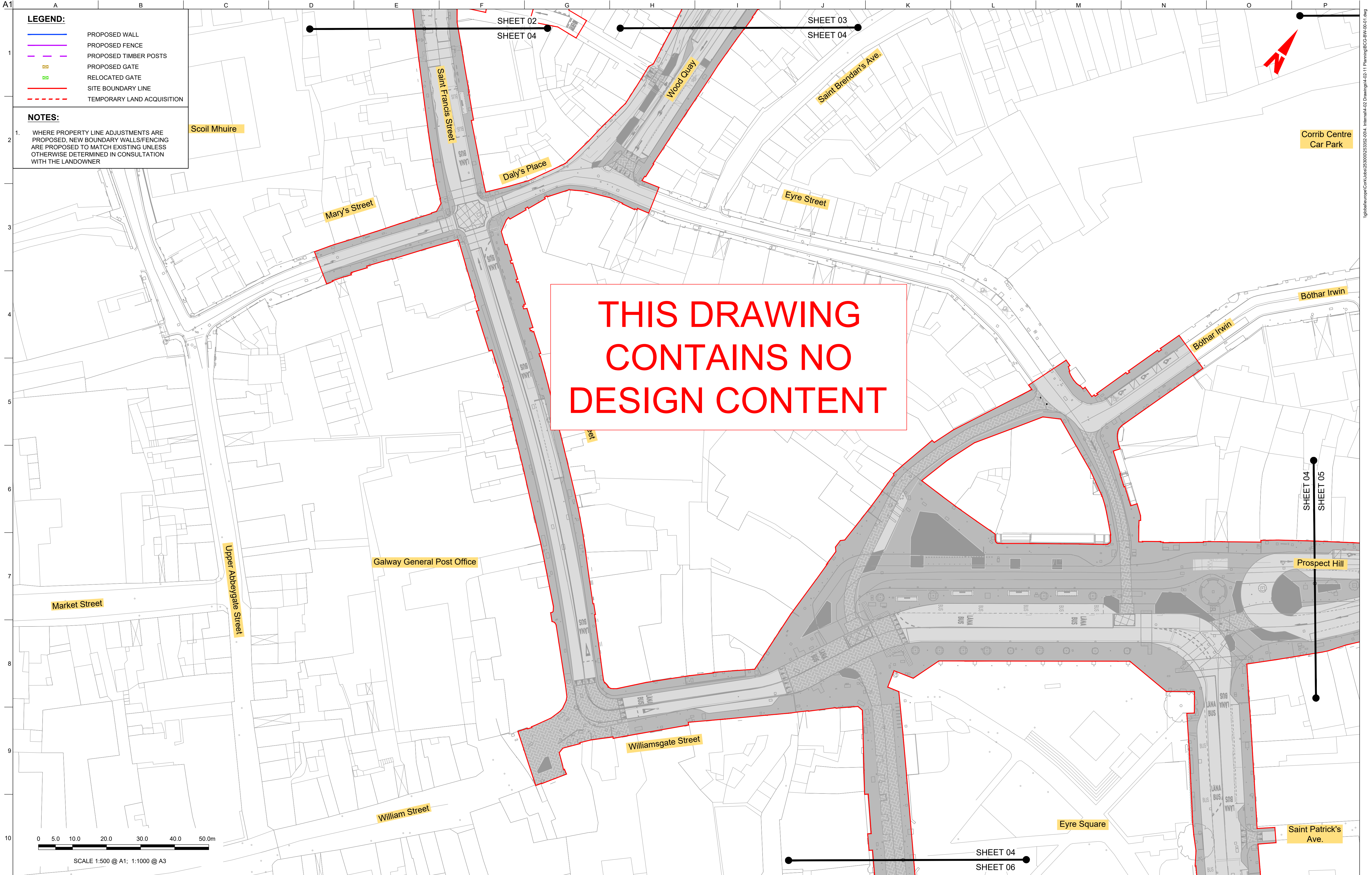

Disclaimer

a. © Galway City Council (GCC) 2022. This drawing is confidential and the copyright in it is owned by GCC. This drawing must not be either loaned, copied or otherwise reproduced in whole or in part or used for any purpose without the prior permission of GCC.

b. This drawing is to be used for the design element identified in the titlebox. Other information shown is to be considered indicative only. The drawing is to be read in conjunction with all other relevant design drawings.

c. O.S. data used for plans are printed under © Ordnance Survey Ireland Government of Ireland. All rights reserved. Licence Number EN 0002822 (Anp). All elevations are in metres and relate to OSI Geoid Model (OSGM15) Mean Head. All Co-ordinates are in Irish Transverse Mercator Grid (ITM) as defined by OSI active local GPS station.

d. Information concerning the position of apparatus shown on this drawing is based on drawings supplied by the utility owners and/or the utility works contractor, whilst every care has been taken in the preparation of this drawing, positions should be taken as approximate and are intended for general guidance only and no representation is made by the GCC as to the accuracy, completeness, sufficiency or otherwise of this drawing and the position of the apparatus. The information contained herein does not purport to be comprehensive or final as the apparatus is subject to being altered and/or suspended. Recipients should not rely on this information. Any liabilities are hereby expressly disclaimed.

e. The information contained herein has been provided by the GCC but does not purport to be comprehensive or final. Recipients should not rely on the information. Neither the GCC nor any of its directors, officers, employees, agents, stakeholders or advisers make any representation or warranty as to, or accept any liability or responsibility in relation to, the adequacy, accuracy, reasonableness or completeness of the information provided as part of this document or any matter on which the information is based (including but not limited to loss or damage arising as a result of reliance by recipients on the information or any part of it). Any liabilities are hereby expressly disclaimed.

ARUP

Arup, One Albert Quay,
Cork, T12 X8N6, Ireland
Tel +353 (0)21 422 3200 Fax +353 (0)1 668 3169
www.arup.ie

Client
Galway City Council

Project Title
**BusConnects Galway:
Cross-City Link
(University Road to Dublin Road)**

Drawing Title
**Fence and Boundary Treatment
Sheet 04 of 13**

Scale at A1
1:500 @ A1 (1:1000 @ A3)

Role	Transport Infrastructure
Suitability	Planning
Arup Job No	253352-00
Name	BCG-BW-00-04
Rev	PL01

PL01	31/08/22	BM	BB	DMcD
Issue for Planning				
Rev	Date	By	Chkd	Appd

Map reproduced from Ordnance Survey Ireland Licence No. EN 0002822
© Ordnance Survey Ireland/ Government of Ireland.

Do not scale

© Arup

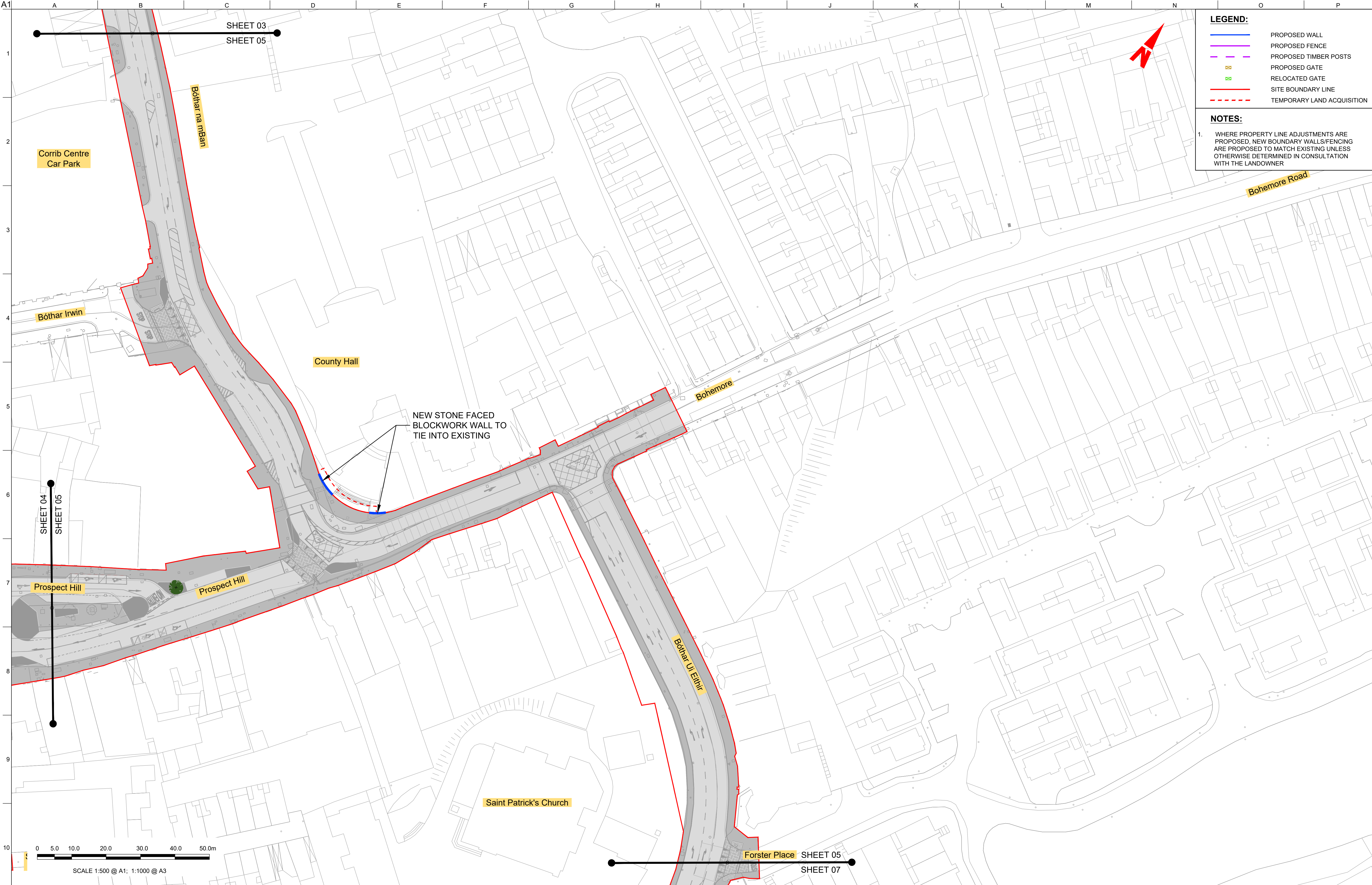

LEGEND:

PROPOSED WALL

PROPOSED FENCE

PROPOSED TIMBER POSTS

PROPOSED GATE

RELOCATED GATE

SITE BOUNDARY LINE

TEMPORARY LAND ACQUISITION

NOTES:

1. WHERE PROPERTY LINE ADJUSTMENTS ARE PROPOSED, NEW BOUNDARY WALLS/FENCING ARE PROPOSED TO MATCH EXISTING UNLESS OTHERWISE DETERMINED IN CONSULTATION WITH THE LANDOWNER

Disclaimer

a. © Galway City Council (GCC) 2022. This drawing is confidential and the copyright in it is owned by GCC. This drawing must not be either loaned, copied or otherwise reproduced in whole or in part or used for any purpose without the prior permission of GCC.

b. This drawing is to be used for the design element identified in the titlebox. Other information shown is to be considered indicative only. The drawing is to be read in conjunction with all other relevant design drawings.

c. O.S. data used for plans are printed under © Ordnance Survey Ireland Government of Ireland. All rights reserved. Licence Number EN 0002822 (Anup). All elevations are in metres and relate to OSI Geoid Model (OSGM15) Mean Head. All Co-ordinates are in Irish Transverse Mercator Grid (ITM) as defined by OSI active local GPS station.

d. Information concerning the position of apparatus shown on this drawing is based on drawings supplied by the utility owners and/or the utility works contractor, whilst every care has been taken in the preparation of this drawing, positions should be taken as approximate and are intended for general guidance only and no representation is made by the GCC as to the accuracy, completeness, sufficiency or otherwise of this drawing and the position of the apparatus. The information contained herein does not purport to be comprehensive or final as the apparatus is subject to being altered and/or suspended. Recipients should not rely on this information. Any liabilities are hereby expressly disclaimed.

e. The information contained herein has been provided by the GCC but does not purport to be comprehensive or final. Recipients should not rely on the information. Neither the GCC nor any of its directors, officers, employees, agents, stakeholders or advisers make any representation or warranty as to, or accept any liability or responsibility in relation to, the adequacy, accuracy, reasonableness or completeness of the information provided as part of this document or any matter on which the information is based (including but not limited to loss or damage arising as a result of reliance by recipients on the information or any part of it). Any liabilities are hereby expressly disclaimed.

NTA

Údarás Náisiúnta Iompair

National Transport Authority

ARUP

Anup, One Albert Quay,
Cork, T12 X8N6, Ireland
Tel +353 (0)21 422 3200 Fax +353 (0)1 668 3169
www.arup.ie

Client

Galway City Council

Project Title

BusConnects Galway:
Cross-City Link
(University Road to Dublin Road)

Drawing Title

Fence and Boundary Treatment
Sheet 05 of 13

Scale at A1

1:500 @ A1 (1:1000 @ A3)

Role

Transport Infrastructure

Suitability

Planning

Arup Job No

253352-00

Rev

PL01

Name

BCG-BW-00-05

Map reproduced from Ordnance Survey Ireland Licence No. EN 0002822
© Ordnance Survey Ireland/ Government of Ireland.

Do not scale

© Anup

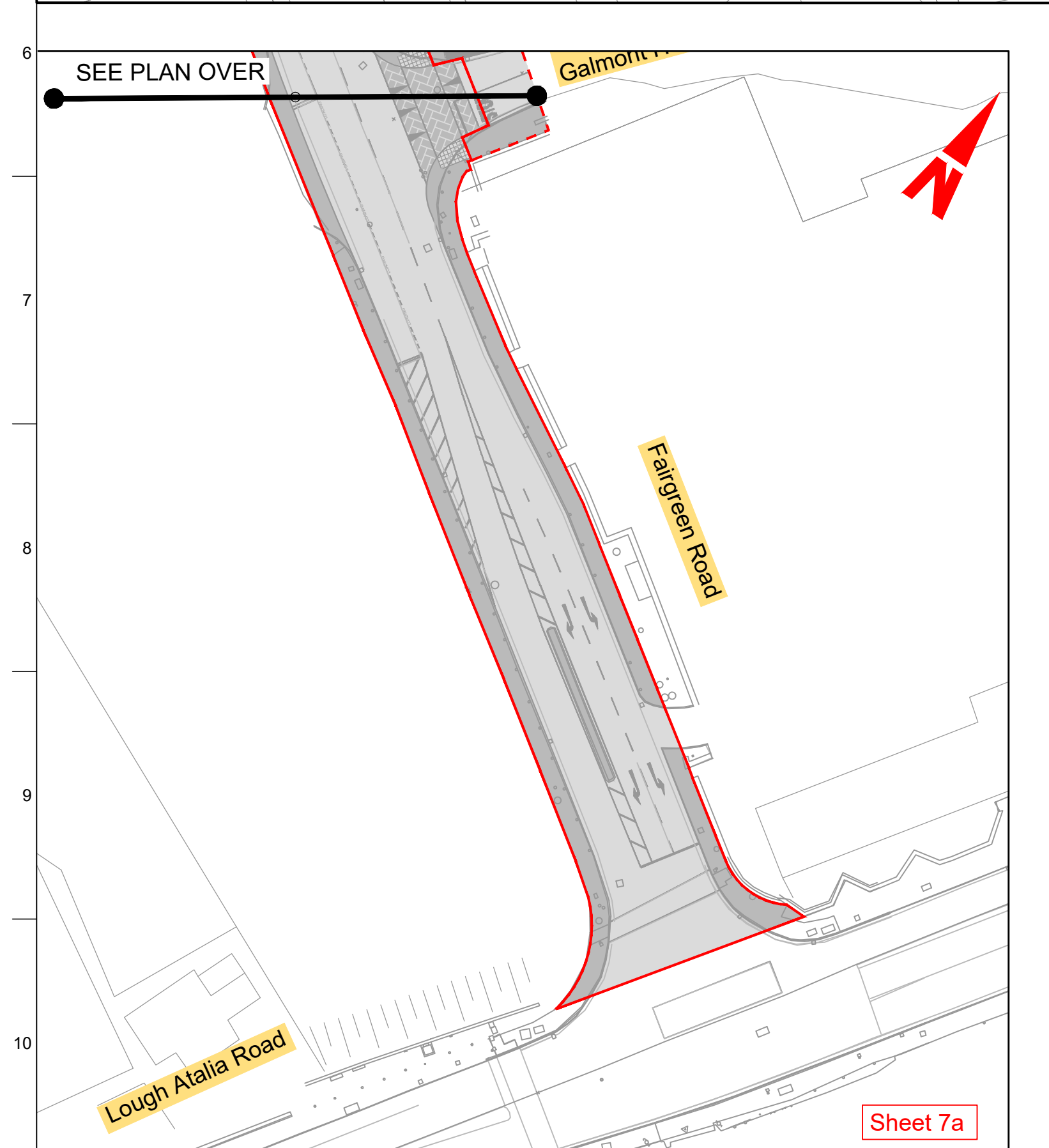
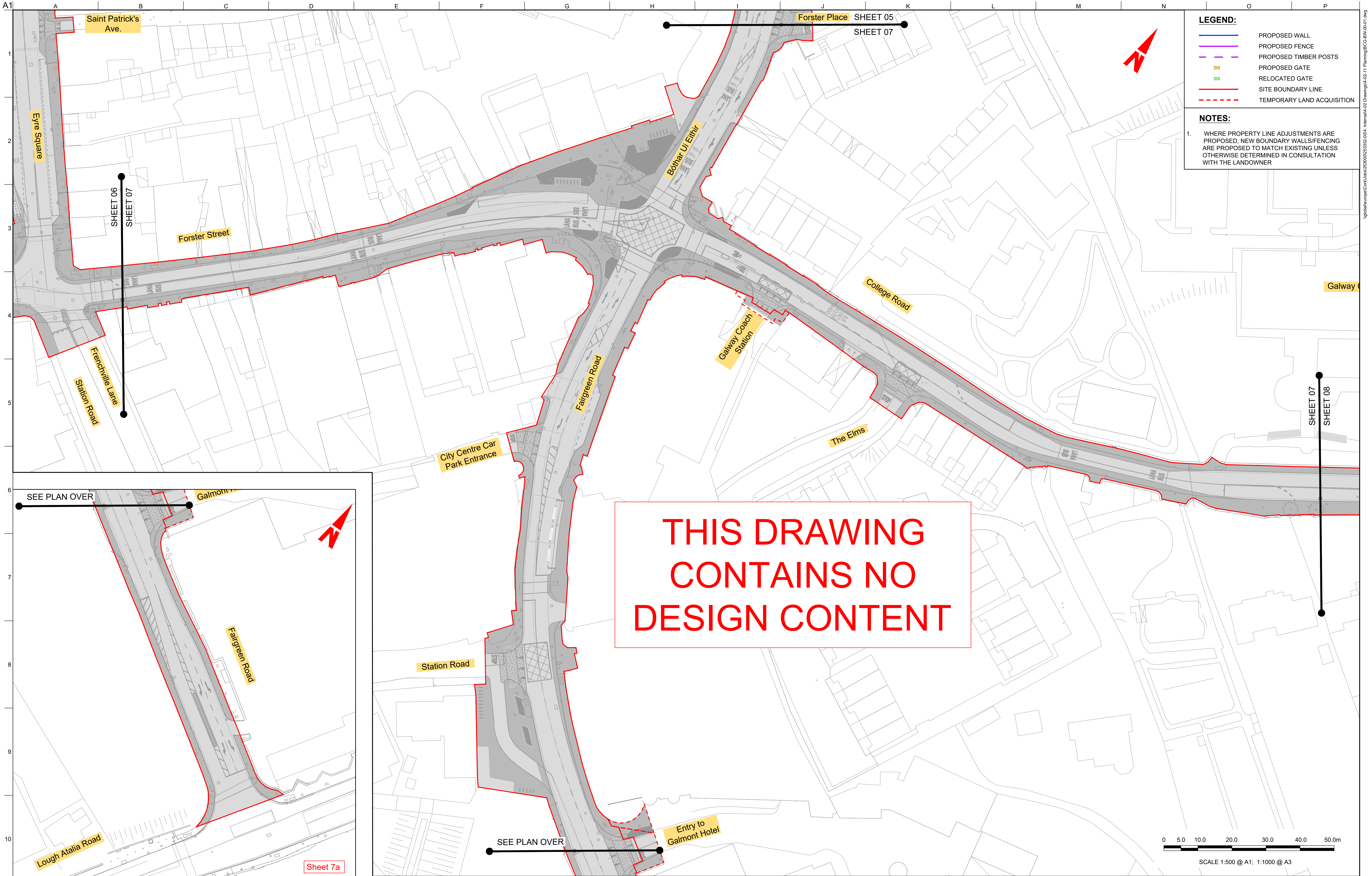

Disclaimer

a. © Galway City Council (GCC) 2022. This drawing is confidential and the copyright in it is owned by GCC. This drawing must not be either loaned, copied or otherwise reproduced in whole or in part or used for any purpose without the prior permission of GCC.

b. This drawing is to be used for the design element identified in the titlebox. Other information shown is to be considered indicative only. The drawing is to be read in conjunction with all other relevant design drawings.

c. O.S. data used for plans are printed under © Ordnance Survey Ireland Government of Ireland. All rights reserved. Licence Number EN 0002822 (Anp). All elevations are in metres and relate to OSI Geoid Model (OSGM15) Mean Head. All Co-ordinates are in Irish Transverse Mercator Grid (ITM) as defined by OSI active local GPS station.

d. Information concerning the position of apparatus shown on this drawing is based on drawings supplied by the utility owners and/or the utility works contractor, whilst every care has been taken in the preparation of this drawing, positions should be taken as approximate and are intended for general guidance only and no representation is made by the GCC as to the accuracy, completeness, sufficiency or otherwise of this drawing and the position of the apparatus. The information contained herein does not purport to be comprehensive or final as the apparatus is subject to being altered and/or superseded. Recipients should not rely on this information. Any liabilities are hereby expressly disclaimed.

e. The information contained herein has been provided by the GCC but does not purport to be comprehensive or final. Recipients should not rely on the information. Neither the GCC nor any of its directors, officers, employees, agents, stakeholders or advisers make any representation or warranty as to, or accept any liability or responsibility in relation to, the adequacy, accuracy, reasonableness or completeness of the information provided as part of this document or any matter on which the information is based (including but not limited to loss or damage arising as a result of reliance by recipients on the information or any part of it). Any liabilities are hereby expressly disclaimed.

NTA
Údarás Náisiúnta Iompair
National Transport Authority

PL01	31/08/22	BM	BB	DMcD
Issue for Planning				
Rev	Date	By	Chkd	Appd

Arup, One Albert Quay,
Cork, T12 X8N6, Ireland
Tel +353 (0)21 422 3200 Fax +353 (0)1 668 3169
www.arup.ie

Client
Galway City Council

Project Title
**BusConnects Galway:
Cross-City Link
(University Road to Dublin Road)**

Drawing Title
**Fence and Boundary Treatment
Sheet 07 of 13**

Scale at A1
1:500 @ A1 (1:1000 @ A3)

Role Transport Infrastructure	Rev PL01
Suitability Planning	
Arup Job No 253352-00	
Name BCG-BW-00-07	

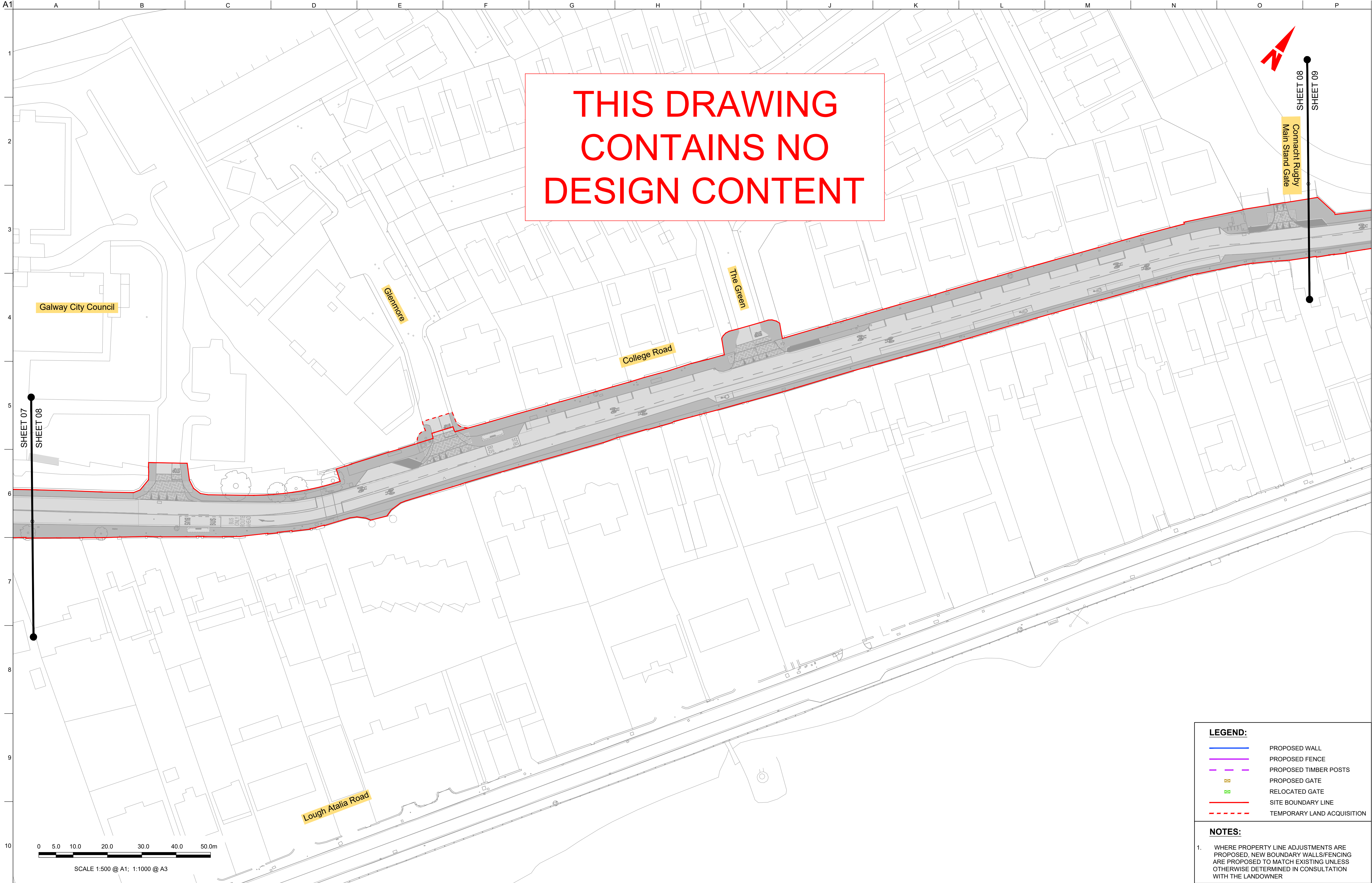

Disclaimer

a. © Galway City Council (GCC) 2022. This drawing is confidential and the copyright in it is owned by GCC. This drawing must not be either loaned, copied or otherwise reproduced in whole or in part or used for any purpose without the prior permission of GCC.

b. This drawing is to be used for the design element identified in the titlebox. Other information shown is to be considered indicative only. The drawing is to be read in conjunction with all other relevant design drawings.

c. O.S. data used for plans are printed under © Ordnance Survey Ireland Government of Ireland. All rights reserved. Licence Number EN 0002822 (Anp). All elevations are in metres and relate to OSI Geoid Model (OSGM15) Mean Sea Level. All Co-ordinates are in Irish Transverse Mercator Grid (ITM) as defined by OSI active local GPS station.

d. Information concerning the position of apparatus shown on this drawing is based on drawings supplied by the utility owners and/or the utility works contractor, whilst every care has been taken in the preparation of this drawing, positions should be taken as approximate and are intended for general guidance only and no representation is made by the GCC as to the accuracy, completeness, sufficiency or otherwise of this drawing and the position of the apparatus. The information contained herein does not purport to be comprehensive or final as the apparatus is subject to being altered and/or suspended. Recipients should not rely on this information. Any liabilities are hereby expressly disclaimed.

e. The information contained herein has been provided by the GCC but does not purport to be comprehensive or final. Recipients should not rely on the information. Neither the GCC nor any of its directors, officers, employees, agents, stakeholders or advisers make any representation or warranty as to, or accept any liability or responsibility in relation to, the adequacy, accuracy, reasonableness or completeness of the information provided as part of this document or any matter on which the information is based (including but not limited to loss or damage arising as a result of reliance by recipients on the information or any part of it). Any liabilities are hereby expressly disclaimed.

NTA

Údarás Náisiúnta Iompair

National Transport Authority

ARUP

Arup, One Albert Quay,
Cork, T12 X8N6, Ireland
Tel +353 (0)21 422 3200 Fax +353 (0)1 668 3169
www.arup.ie

Client

Galway City Council

Project Title

BusConnects Galway:
Cross-City Link
(University Road to Dublin Road)

Drawing Title

Fence and Boundary Treatment
Sheet 08 of 13

Scale at A1 1:500 @ A1 (1:1000 @ A3)

Role	Transport Infrastructure
Suitability	Planning
Arup Job No	253352-00
Name	BCG-BW-00-08
Rev	PL01

PL01	31/08/22	BM	BB	DMcD
Issue for Planning				
Rev	Date	By	Chkd	Appd

Map reproduced from Ordnance Survey Ireland Licence No. EN 0002822
© Ordnance Survey Ireland/ Government of Ireland.

Do not scale

© Arup

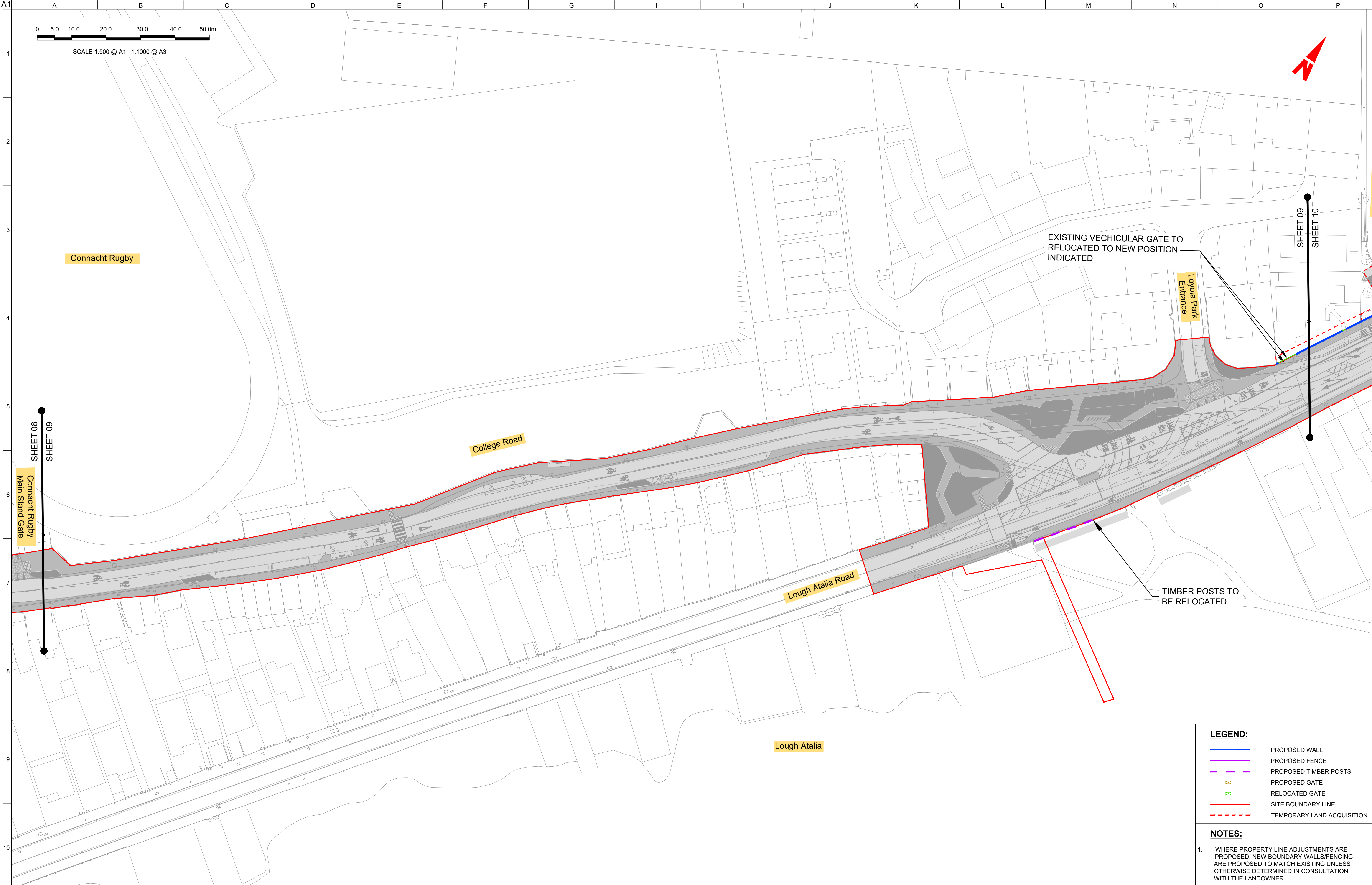

Disclaimer

a. © Galway City Council (GCC) 2022. This drawing is confidential and the copyright in it is owned by GCC. This drawing must not be either loaned, copied or otherwise reproduced in whole or in part or used for any purpose without the prior permission of GCC.

b. This drawing is to be used for the design element identified in the titlebox. Other information shown is to be considered indicative only. The drawing is to be read in conjunction with all other relevant design drawings.

c. O.S. data used for plans are printed under © Ordnance Survey Ireland Government of Ireland. All rights reserved. Licence Number EN 0002822 (Anú). All elevations are in metres and relate to OSI Geoid Model (OSGM15) Mean Sea Level. All Co-ordinates are in Irish Transverse Mercator Grid (ITM) as defined by OSI active local GPS station.

d. Information concerning the position of apparatus shown on this drawing is based on drawings supplied by the utility owners and/or the utility works contractor, whilst every care has been taken in the preparation of this drawing, positions should be taken as approximate and are intended for general guidance only and no representation is made by the GCC as to the accuracy, completeness, sufficiency or otherwise of this drawing and the position of the apparatus. The information contained herein does not purport to be comprehensive or final as the apparatus is subject to being altered and/or suspended. Recipients should not rely on this information. Any liabilities are hereby expressly disclaimed.

e. The information contained herein has been provided by the GCC but does not purport to be comprehensive or final. Recipients should not rely on the information. Neither the GCC nor any of its directors, officers, employees, agents, stakeholders or advisers make any representation or warranty as to, or accept any liability or responsibility in relation to, the adequacy, accuracy, reasonableness or completeness of the information provided as part of this document or any matter on which the information is based (including but not limited to loss or damage arising as a result of reliance by recipients on the information or any part of it). Any liabilities are hereby expressly disclaimed.

ARUP

Arup, One Albert Quay,
Cork, T12 X8N6, Ireland
Tel +353 (0)21 422 3200 Fax +353 (0)1 668 3169
www.arup.ie

Client
Galway City Council

Project Title
**BusConnects Galway:
Cross-City Link
(University Road to Dublin Road)**

Drawing Title
**Fence and Boundary Treatment
Sheet 09 of 13**

Scale at A1
1:500 @ A1 (1:1000 @ A3)

Role	Transport Infrastructure
Suitability	Planning
Arup Job No	253352-00
Name	BCG-BW-00-09
Rev	PL01

Map reproduced from Ordnance Survey Ireland Licence No. EN 0002822
© Ordnance Survey Ireland/ Government of Ireland.

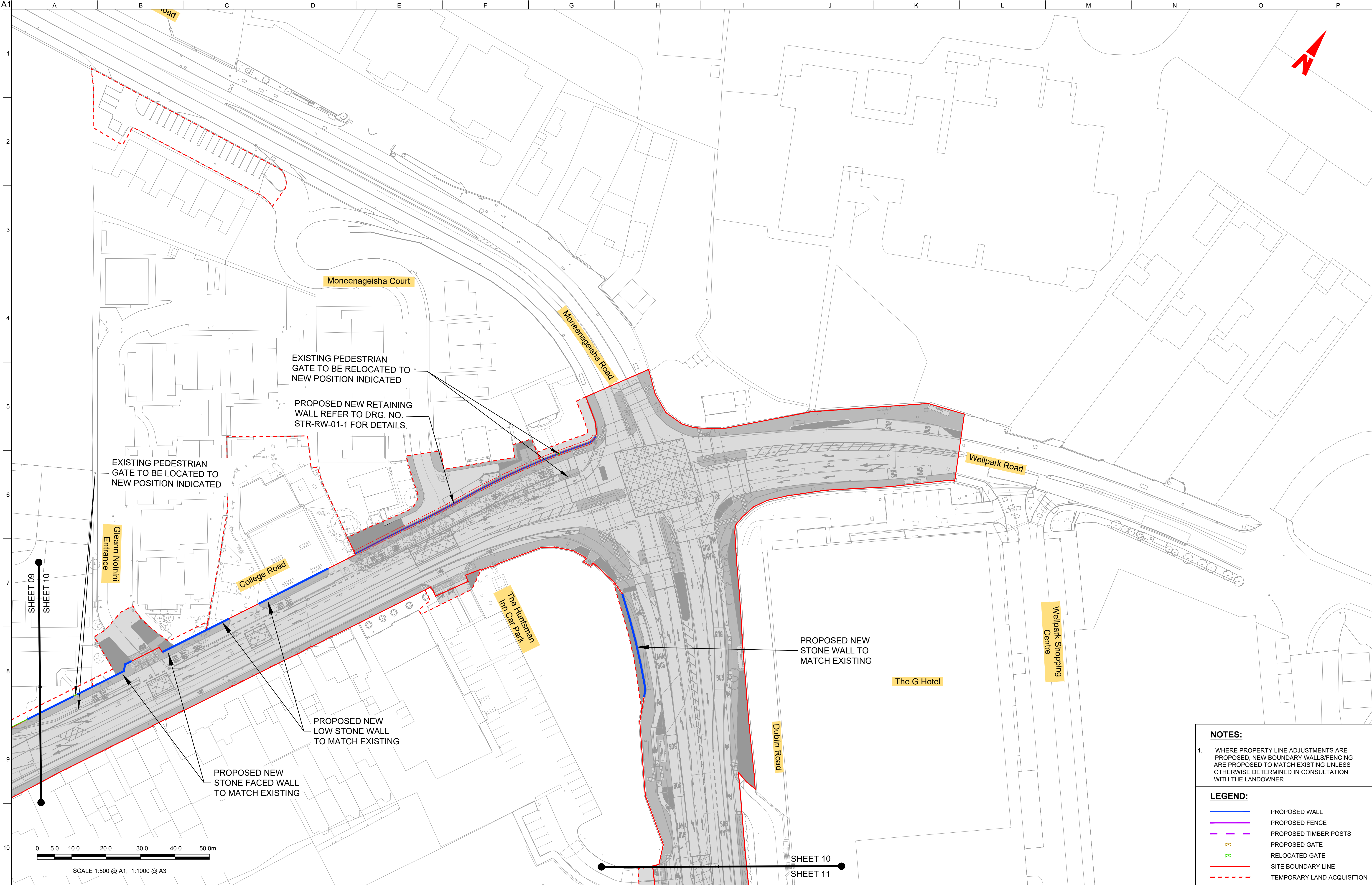

NOTES:
1. WHERE PROPERTY LINE ADJUSTMENTS ARE PROPOSED, NEW BOUNDARY WALLS/FENCING ARE PROPOSED TO MATCH EXISTING UNLESS OTHERWISE DETERMINED IN CONSULTATION WITH THE LANDOWNER

LEGEND:

PROPOSED WALL

PROPOSED FENCE

PROPOSED TIMBER POSTS

PROPOSED GATE

RELOCATED GATE

SITE BOUNDARY LINE

TEMPORARY LAND ACQUISITION

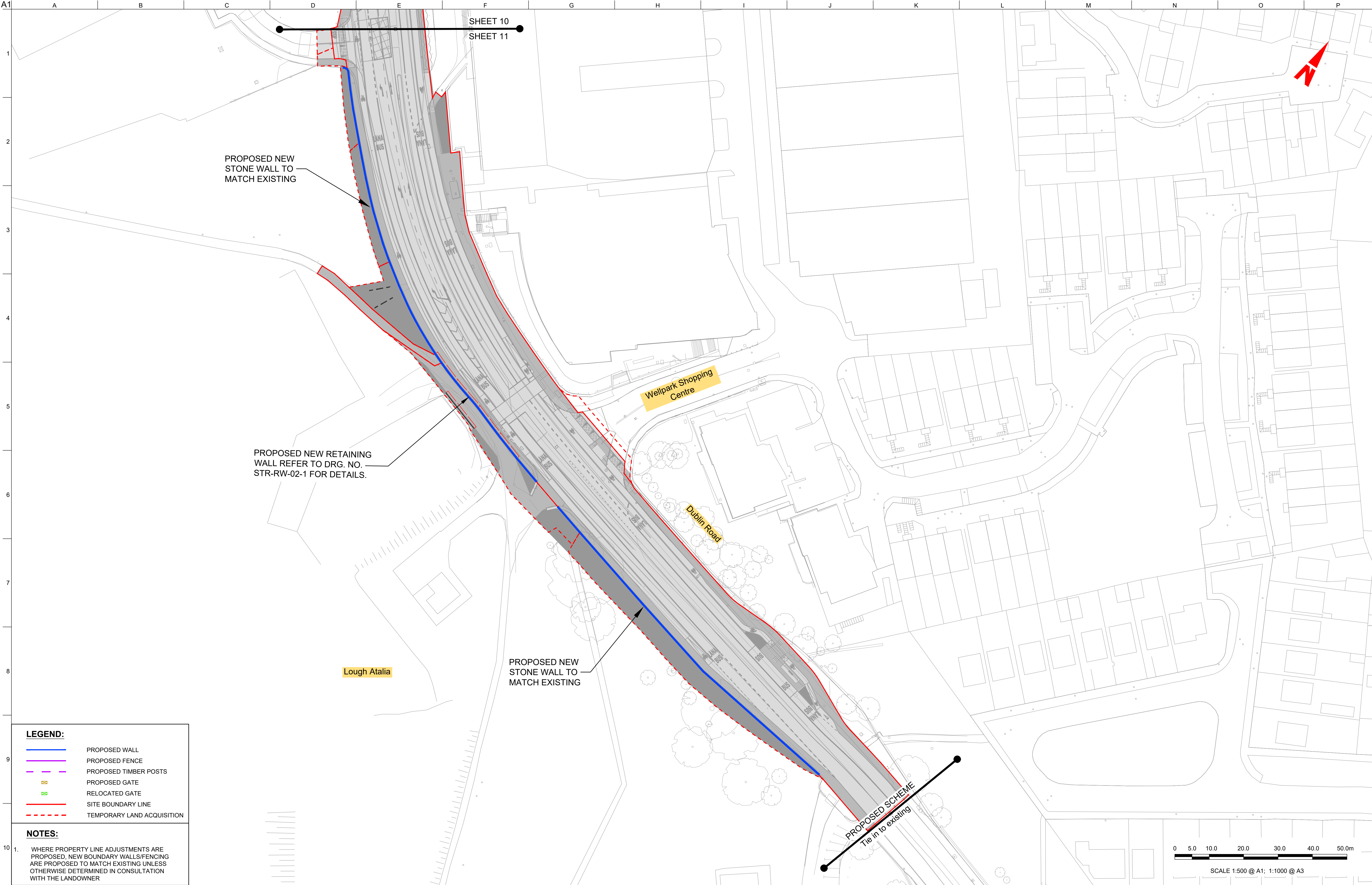

LEGEND:

- PROPOSED WALL
- PROPOSED FENCE
- PROPOSED TIMBER POSTS
- PROPOSED GATE
- RELOCATED GATE
- SITE BOUNDARY LINE
- TEMPORARY LAND ACQUISITION

NOTES:

1. WHERE PROPERTY LINE ADJUSTMENTS ARE PROPOSED, NEW BOUNDARY WALLS/FENCING ARE PROPOSED TO MATCH EXISTING UNLESS OTHERWISE DETERMINED IN CONSULTATION WITH THE LANDOWNER

Disclaimer

a. © Galway City Council (GCC) 2022. This drawing is confidential and the copyright in it is owned by GCC. This drawing must not be either loaned, copied or otherwise reproduced in whole or in part or used for any purpose without the prior permission of GCC.

b. This drawing is to be used for the design element identified in the titlebox. Other information shown is to be considered indicative only. The drawing is to be read in conjunction with all other relevant design drawings.

c. O.S. data used for plans are printed under © Ordnance Survey Ireland Government of Ireland. All rights reserved. Licence Number EN 0002822 (Anup). All elevations are in metres and relate to OSI Geoid Model (OSGM15) Mean Head. All Co-ordinates are in Irish Transverse Mercator Grid (ITM) as defined by OSI active local GPS station.

d. Information concerning the position of apparatus shown on this drawing is based on drawings supplied by the utility owners and/or the utility works contractor, whilst every care has been taken in the preparation of this drawing, positions should be taken as approximate and are intended for general guidance only and no representation is made by the GCC as to the accuracy, completeness, sufficiency or otherwise of this drawing and the position of the apparatus. The information contained herein does not purport to be comprehensive or final as the apparatus is subject to being altered and/or suspended. Recipients should not rely on this information. Any liabilities are hereby expressly disclaimed.

e. The information contained herein has been provided by the GCC but does not purport to be comprehensive or final. Recipients should not rely on the information. Neither the GCC nor any of its directors, officers, employees, agents, stakeholders or advisers make any representation or warranty as to, or accept any liability or responsibility in relation to, the adequacy, accuracy, reasonableness or completeness of the information provided as part of this document or any matter on which the information is based (including but not limited to loss or damage arising as a result of reliance by recipients on the information or any part of it). Any liabilities are hereby expressly disclaimed.

ARUP

Arup, One Albert Quay,
Cork, T12 X8N6, Ireland
Tel +353 (0)21 422 3200 Fax +353 (0)1 668 3169
www.arup.ie

Client
Galway City Council

Project Title
**BusConnects Galway:
Cross-City Link
(University Road to Dublin Road)**

Drawing Title
**Fence and Boundary Treatment
Sheet 11 of 13**

Scale at A1
1:500 @ A1 (1:1000 @ A3)

Role	Transport Infrastructure
Suitability	Planning
Arup Job No	253352-00
Name	BCG-BW-00-11
Rev	PL01

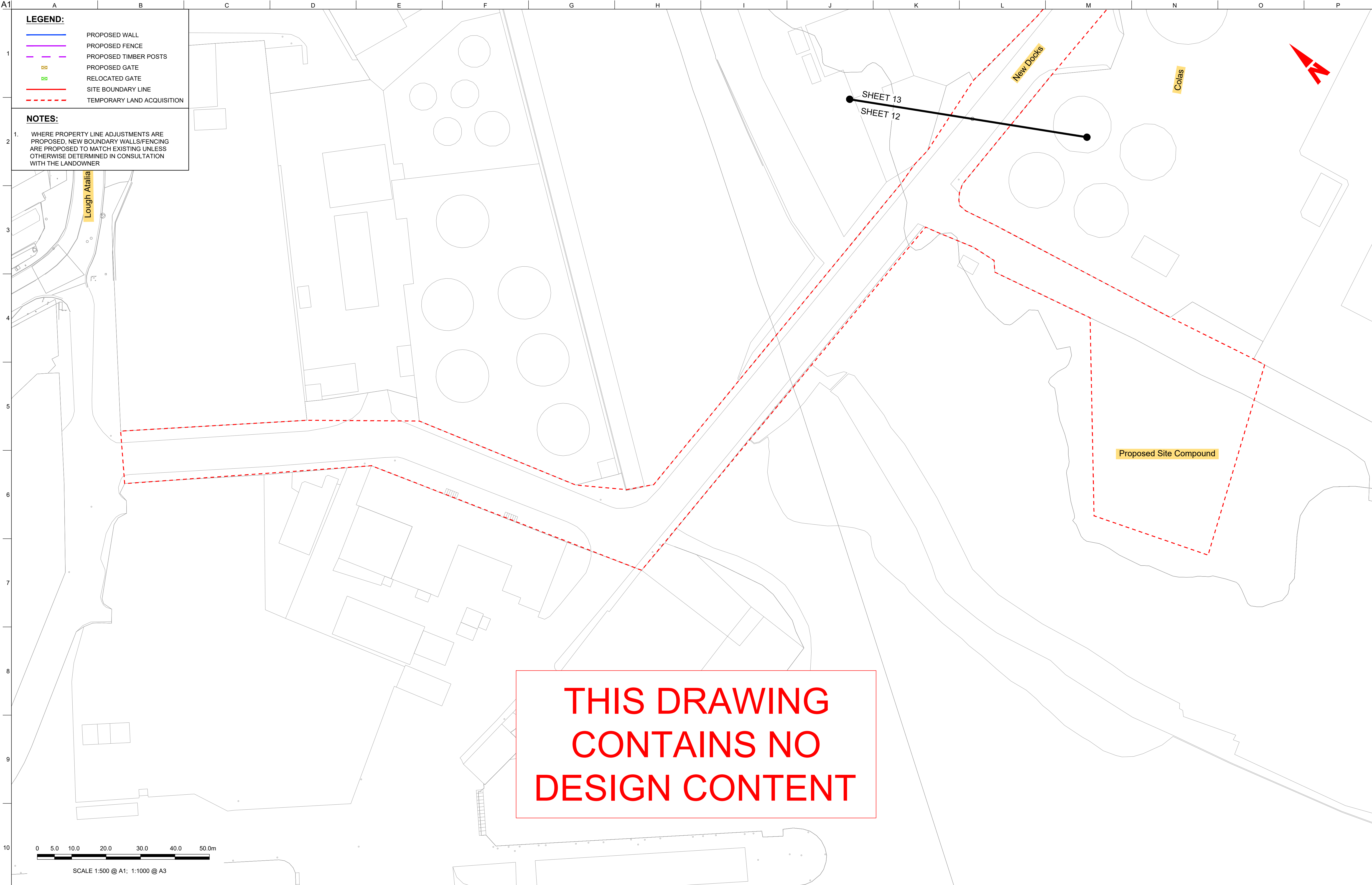

LEGEND:

- PROPOSED WALL
- PROPOSED FENCE
- PROPOSED TIMBER POSTS
- PROPOSED GATE
- RELOCATED GATE
- SITE BOUNDARY LINE
- TEMPORARY LAND ACQUISITION

NOTES:

1. WHERE PROPERTY LINE ADJUSTMENTS ARE PROPOSED, NEW BOUNDARY WALLS/FENCING ARE PROPOSED TO MATCH EXISTING UNLESS OTHERWISE DETERMINED IN CONSULTATION WITH THE LANDOWNER

0 5.0 10.0 20.0 30.0 40.0 50.0m

SCALE 1:500 @ A1; 1:1000 @ A3

THIS DRAWING CONTAINS NO DESIGN CONTENT

Disclaimer

a. © Galway City Council (GCC) 2022. This drawing is confidential and the copyright in it is owned by GCC. This drawing must not be either loaned, copied or otherwise reproduced in whole or in part or used for any purpose without the prior permission of GCC.

b. This drawing is to be used for the design element identified in the titlebox. Other information shown is to be considered indicative only. The drawing is to be read in conjunction with all other relevant design drawings.

c. O.S. data used for plans are printed under © Ordnance Survey Ireland Government of Ireland. All rights reserved. Licence Number EN 0002822 (Anup). All elevations are in metres and relate to OSI Geoid Model (OSGM15) Mean Head. All Co-ordinates are in Irish Transverse Mercator Grid (ITM) as defined by OSI active local GPS station.

d. Information concerning the position of apparatus shown on this drawing is based on drawings supplied by the utility owners and/or the utility works contractor, whilst every care has been taken in the preparation of this drawing, positions should be taken as approximate and are intended for general guidance only and no representation is made by the GCC as to the accuracy, completeness, sufficiency or otherwise of this drawing and the position of the apparatus. The information contained herein does not purport to be comprehensive or final as the apparatus is subject to being altered and/or suspended. Recipients should not rely on this information. Any liabilities are hereby expressly disclaimed.

e. The information contained herein has been provided by the GCC but does not purport to be comprehensive or final. Recipients should not rely on the information. Neither the GCC nor any of its directors, officers, employees, agents, stakeholders or advisers make any representation or warranty as to, or accept any liability or responsibility in relation to, the adequacy, accuracy, reasonableness or completeness of the information provided as part of this document or any matter on which the information is based (including but not limited to loss or damage arising as a result of reliance by recipients on the information or any part of it). Any liabilities are hereby expressly disclaimed.

NTA
Údarás Náisiúnta Iompair
National Transport Authority

ARUP

Anup, One Albert Quay,
Cork, T12 X8N6, Ireland
Tel +353 (0)21 422 3200 Fax +353 (0)1 668 3169
www.arup.ie

Client
Galway City Council

Project Title
BusConnects Galway:
Cross-City Link
(University Road to Dublin Road)

Drawing Title
Fence and Boundary Treatment
Sheet 12 of 13

Scale at A1 1:500 @ A1 (1:1000 @ A3)

Role	Transport Infrastructure
Suitability	Planning
Arup Job No	253352-00
Name	BCG-BW-00-12
Rev	PL01

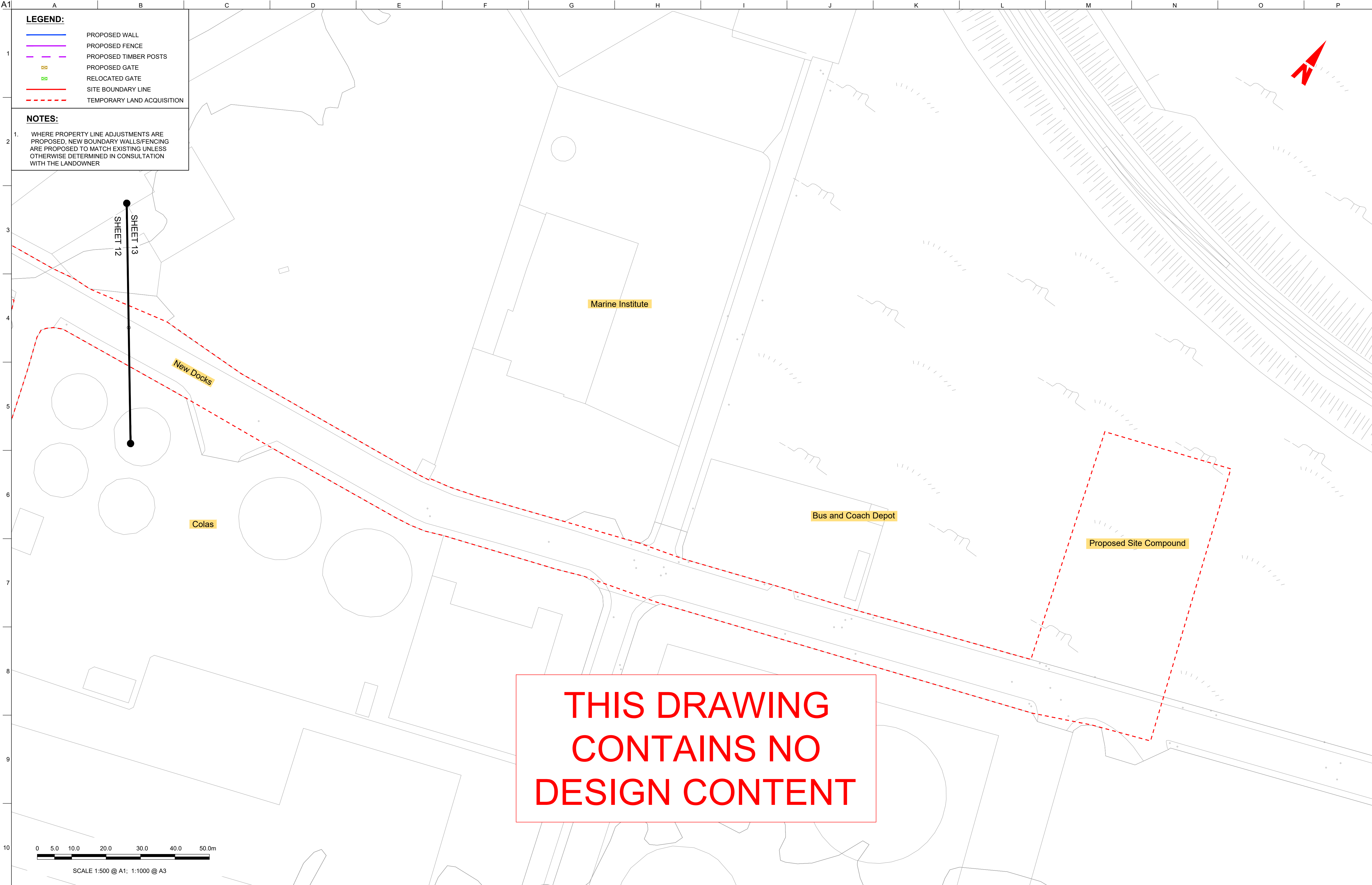

Disclaimer

a. © Galway City Council (GCC) 2022. This drawing is confidential and the copyright in it is owned by GCC. This drawing must not be either loaned, copied or otherwise reproduced in whole or in part or used for any purpose without the prior permission of GCC.

b. This drawing is to be used for the design element identified in the titlebox. Other information shown is to be considered indicative only. The drawing is to be read in conjunction with all other relevant design drawings.

c. O.S. data used for plans are printed under © Ordnance Survey Ireland Government of Ireland. All rights reserved. Licence Number EN 0002822 (Anup). All elevations are in metres and relate to OSI Geoid Model (OSGM15) Mean High Water. All Co-ordinates are in Irish Transverse Mercator Grid (ITM) as defined by OSI active local GPS station.

d. Information concerning the position of apparatus shown on this drawing is based on drawings supplied by the utility owners and/or the utility works contractor, whilst every care has been taken in the preparation of this drawing, positions should be taken as approximate and are intended for general guidance only and no representation is made by the GCC as to the accuracy, completeness, sufficiency or otherwise of this drawing and the position of the apparatus. The information contained herein does not purport to be comprehensive or final as the apparatus is subject to being altered and/or suspended. Recipients should not rely on this information. Any liabilities are hereby expressly disclaimed.

e. The information contained herein has been provided by the GCC but does not purport to be comprehensive or final. Recipients should not rely on the information. Neither the GCC nor any of its directors, officers, employees, agents, stakeholders or advisers make any representation or warranty as to, or accept any liability or responsibility in relation to, the adequacy, accuracy, reasonableness or completeness of the information provided as part of this document or any matter on which the information is based (including but not limited to loss or damage arising as a result of reliance by recipients on the information or any part of it). Any liabilities are hereby expressly disclaimed.

NTA
Údarás Náisiúnta Iompair
National Transport Authority

PL01	31/08/22	BM	BB	DMcD
Issue for Planning				
Rev	Date	By	Chkd	Appd

Arup, One Albert Quay,
Cork, T12 X8N6, Ireland
Tel +353 (0)21 422 3200 Fax +353 (0)1 668 3169
www.arup.ie

Client
Galway City Council

Project Title
BusConnects Galway:
Cross-City Link
(University Road to Dublin Road)

Drawing Title
Fence and Boundary Treatment
Sheet 13 of 13

Scale at A1 1:500 @ A1 (1:1000 @ A3)

Role	Transport Infrastructure
Suitability	Planning
Arup Job No	253352-00
Name	BCG-BW-00-12
Rev	PL01